

Pit Seal Breaker instructions

Introduction

Thank you for your purchase of the pit seal breaker, the tool has been designed to assist in breaking the sealing edge on various lids and covers. Please read the instructions before use.

Warning

Do NOT overload the tool (the long turning bar provides very effective leverage)

It is recommended not to exceed 75kgs of force on the turning handle.

Overloading of the tool can deform the load bar and cause stretching or breakage of the T bolt.

Components

1. Turning bar
2. Pressure bolt
3. Load bar
4. T Bolt & nut/washer

Assemble - Pit seal breaker is easily assembled

1. Insert the T bolt into one of the load bar holes and secure loosely with supplied washer & nut.

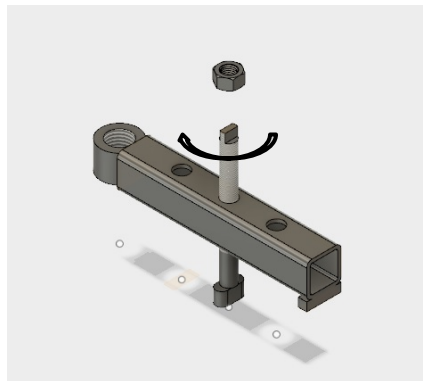

2. Insert and screw pressure bolt into threaded load bar nut.

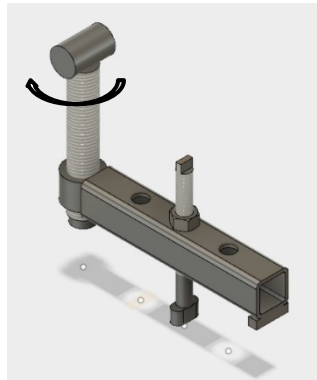

3. Insert turning bar into pipe head of pressure bolt.

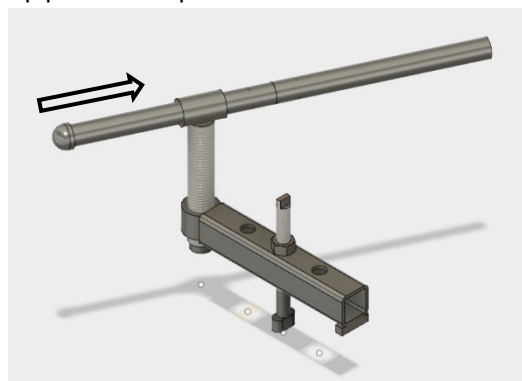

Note the high force applied from the pressure bolt can damage the surface which the pressure bolt is pushing against. It is advisable to use a protective material between pressure bolt head and surface material.

Recommended Setup

1. Remove the handle when setting up, unwind the pressure bolt so the bottom of the pressure bolt is level with the bottom of the load bar heel, and slacken the t bolt nut so there is plenty of movement in the t bolt shaft.
2. With the T bolt located in the desired hole on the load bar, insert the head of the T bolt into the lid/cover slot and turn 90 degrees (note: the tongue on top of the T bolt is in line with the bottom head of the T bolt, this indicates the position of the bottom head). Tighten the T bolt nut to load bar.

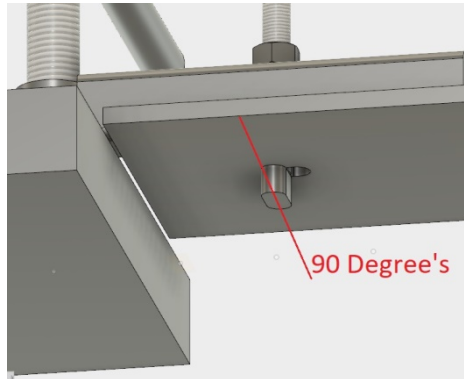

3. Hand tighten the pressure bolt down against pit frame
4. Insert turning handle and rotate in a clockwise direction to apply pressure on pit seal (do not over load tool)

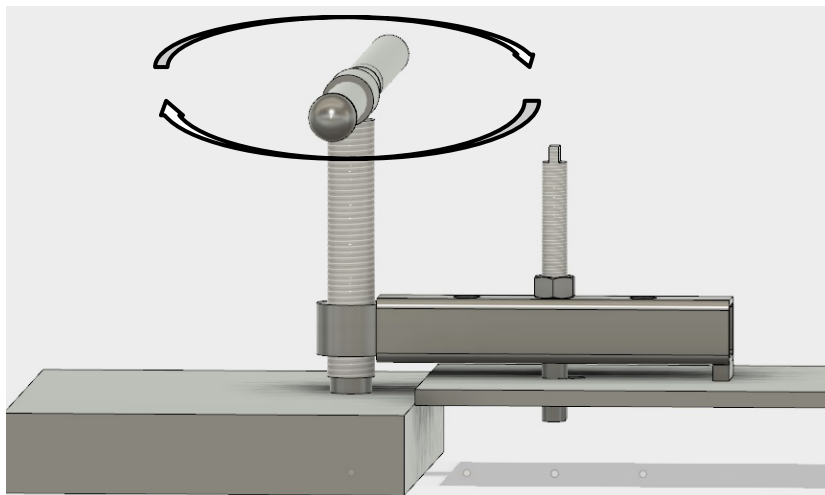

Tool care

Lubricate pressure bolt & t bolt thread to reduce friction wear and protect against elements/chemicals.

